

SIGNAL STANDARD SCHEDULE					
No.	TYPE	FOUND. TYPE	PED. PUSH BUT'N TYPE	PHASE	REMARKS
1	Overhead	PF22			Custom 4.6m (20') Cantilever Arms.

ESTIMATED MATERIAL FURNISHED BY LADOT	
UNITS	MATERIAL

ESTIMATED SALVAGE MATERIAL TO BE RETURNED TO LADOT	
UNITS	MATERIAL

CONDUCTOR SCHEDULE		
SIZE No.	CABLE / WIRE	RUN
5	CONDUCTOR CABLE	
5	5 X #14	
9	CONDUCTOR CABLE	
8	8 X #14 & 1 X #12 (COM)	
12	CONDUCTOR CABLE	
11	11 X #14 & 1 X #12 (COM)	
28	CONDUCTOR CABLE	
27	27 X #14 & 1 X #10 (COM)	
SERVICE		
14	PED PUSH BUTTON	
18	DLC (2 PAIR)	
16	DLC (EXISTING)	
14	INTERCONNECT (7 WIRE)	
22	INTERCONNECT (12 PAIR)	
CONDUIT SIZE		

NOTES:

- INSTALL NON-ILLUMINATED REFLECTORIZED OVERHEAD SIGN PER DETAIL "A" ON 6.1 m (20 FT.) CANTILEVER ARM AND PF-22 FOUNDATION PER LADOT STD. DWG NO. S-92.3 AT LOCATION ①. REFER TO LADOT STD. DWG. NO. S-45.0 FOR NON-ILLUMINATED SIGN PANEL STRUCTURAL DETAIL.
- INSTALL/REMOVE STRIPING, PAVEMENT MARKING, AND SIGNS PER LADOT GEOMETRIC DESIGN PLAN NO. A-3166.

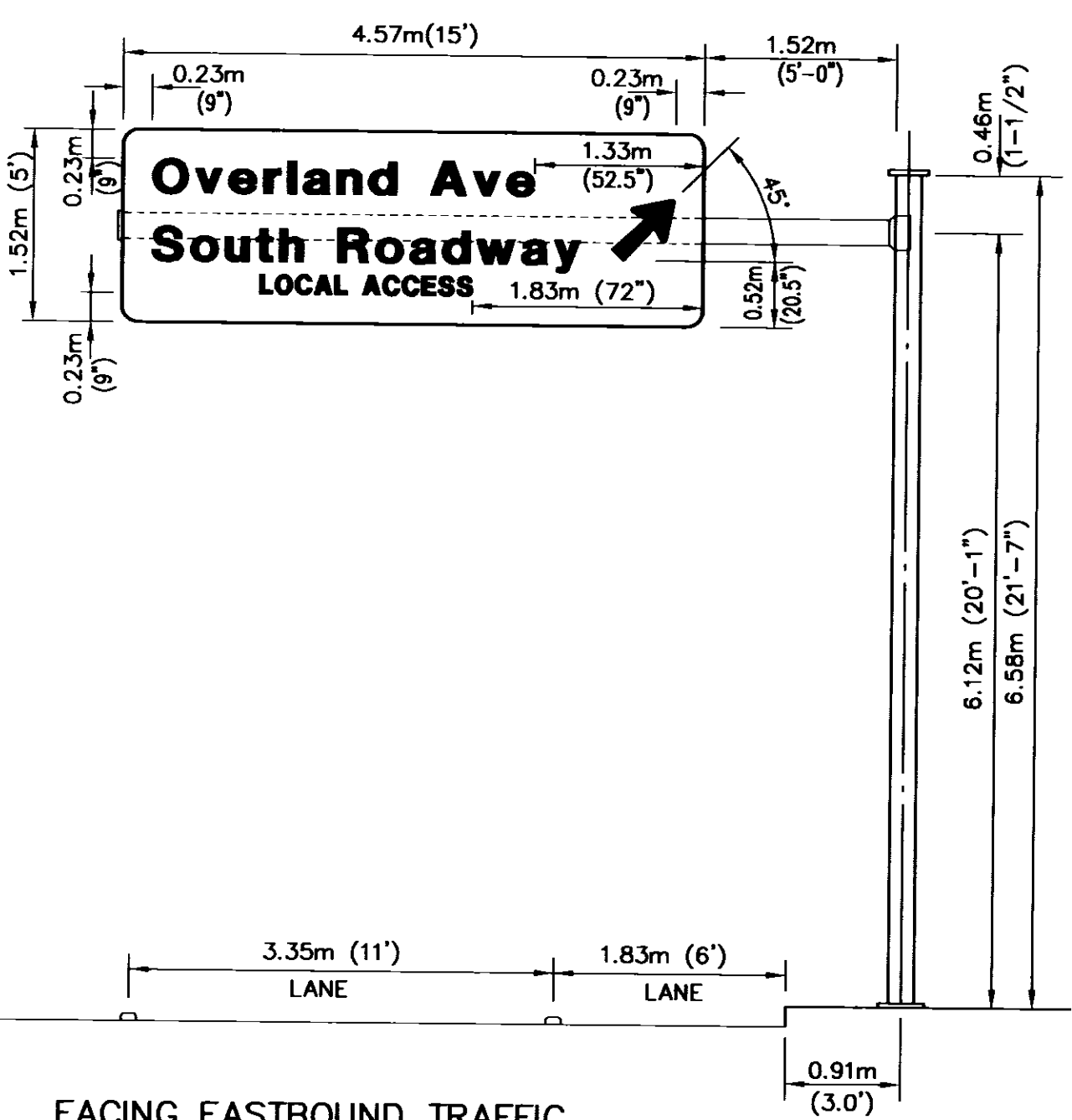
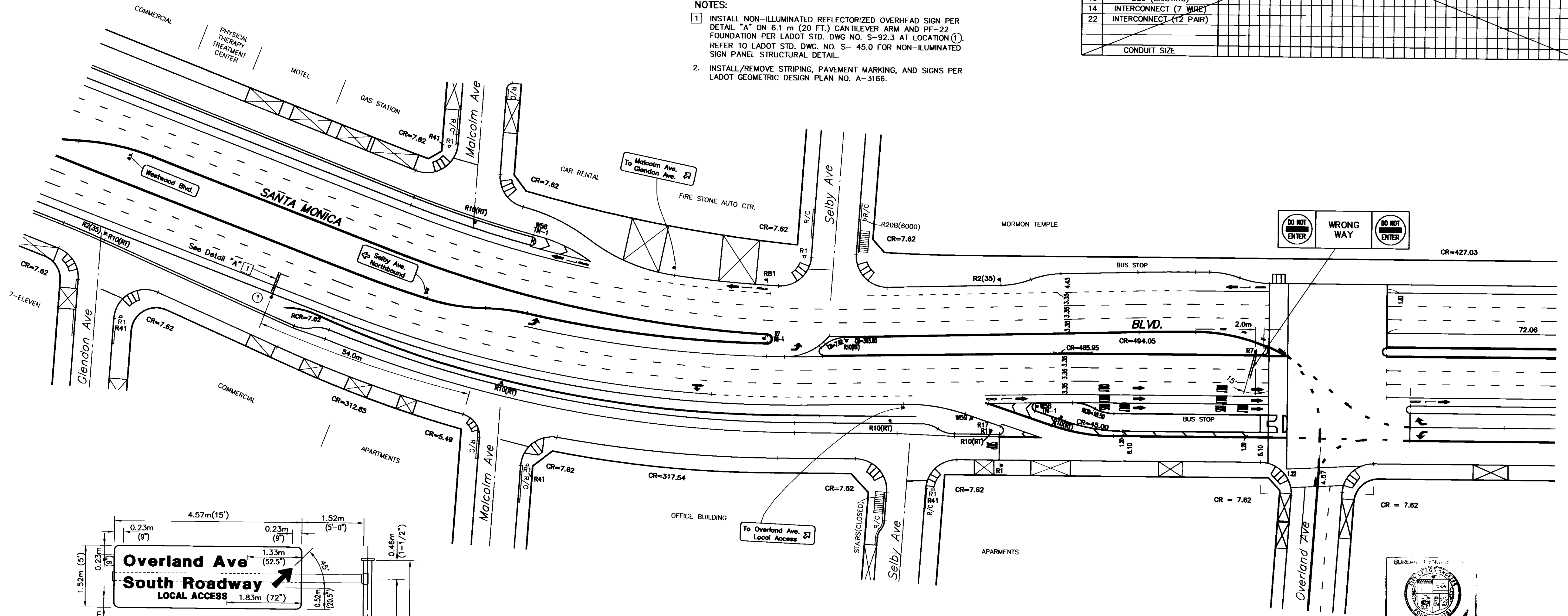
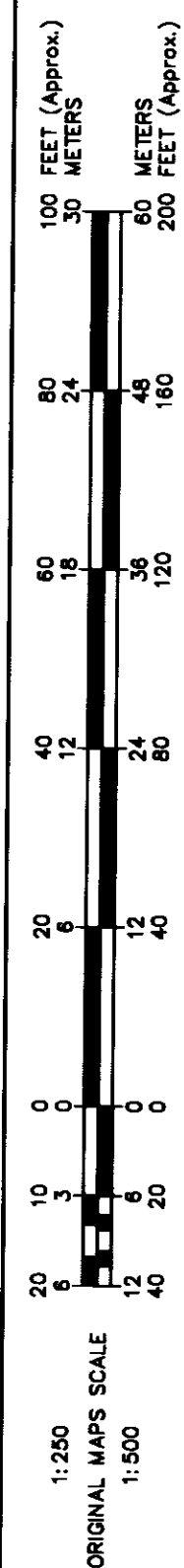

GUIDE SIGN:

- 4.6m W X 1.5m H (15' W X 5'H)
- U.C. - 270mm (10.7")
L.C. - 200mm (8")
- SUPPLEMENTAL WORDING - CAP - 150mm (6") SERIES D
- DIVISION AND BORDER LINES - 38mm (1.5") STROKE
- ARROW - TWO LINE DIAGONAL ARROW PER LADOT STD. NO S-418.6
- REFLECTORIZED SHEETING - WHITE LEGEND (DIAMOND GRADE/MP) ON GREEN BACKGROUND (HIGH INTENSITY)

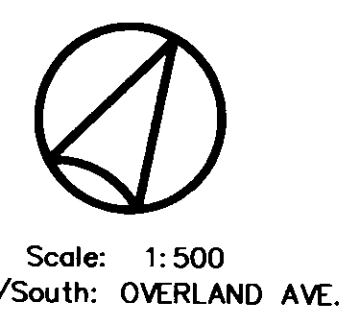

FACING EASTBOUND TRAFFIC
DETAIL "A"
Scale: 1:50

SANTA MONICA BLVD. TRANSIT PARKWAY PROJECT

RECOMMENDED: May 15, 2002
APPROVED: May 15, 2002
Thomas Van Der Laan Transportation Engineer
Thomas L. Jones Senior Transportation Engineer

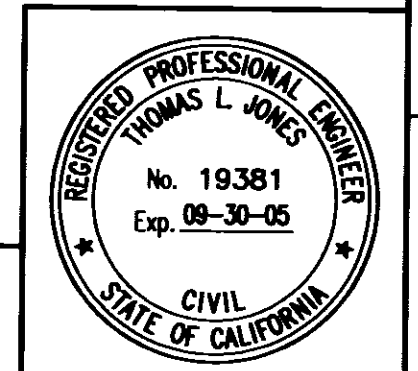

AS BUILT		CITY OF LOS ANGELES DEPARTMENT OF TRANSPORTATION RITA L. ROBINSON, General Manager	
Date of Installation:		TITLE	OVERHEAD SIGN
LADOT Inspector:			SANTA MONICA BLVD. Bet. GLENDON AVE. & MALCOLM AVE. (EASTBOUND)
Condition As Of:		File Name	OH17820-N3.DWG
LADOT Engineer:		Intersection No.	
District:	WESTERN	Project No.	90297
Thomas Guide	632 E2	NOTICE: IF PLAN HAS NOT BEEN IMPLEMENTED WITHIN TWO (2) YEARS OF THE APPROVAL DATE, IT MUST BE RESUBMITTED TO LADOT SIGNAL DESIGN SECTION FOR REVIEW AND APPROVAL.	
References			
Geometric Design Plan	A-3166/3		