

SIGNAL STANDARD SCHEDULE					
No.	TYPE	FOUND. TYPE	PED. PUSH BUTN	PHASE	REMARKS
1	332 Cab.	Exist F-332			ATSAC 2070 Controller in 332 Cabinet
2	26-4-129	CIDH***	0.15	6	Custom 9.1 M.A.
3	BSL*	BSL*	0.15	4	
4	DAVIT*	CIDH**	0.15	4	16.8 M.A.; 29-5-129 Foundation
5	CD953C*	BSL*	0.15	2	
6	26-4-129	CIDH***	0.15	2	Custom 10.67 M.A.
7	BSL*	BSL*	0.15	8	
8	CMS	CIDH +			.91 x 3.66 Changeable Message Sign
9	337 Cab.	F-8			CMS Auxiliary Cabinet
10	DAVIT*	CIDH**	0.15	8	16.8 M.A.; 29-5-129 Foundation
11	CD953C*	BSL*	0.15	6	

\* For Reference Only. See Street Lighting Sheet  
 \*\* Per CALTRANS Std. Plan No. ES-7G, ES-7M, ES-7N  
 \*\*\* Per CALTRANS Std. Plan No. ES-7F, ES-7M, ES-7N  
 + Per CALTRANS Std. Plan No. S13, Post Type V

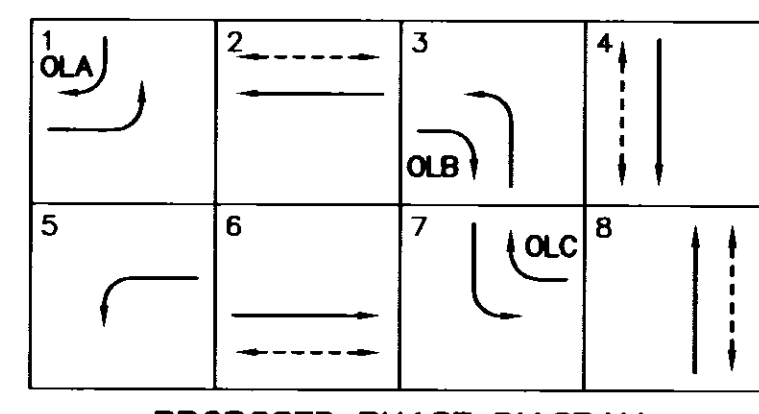

ESTIMATED SALVAGE MATERIAL TO BE RETURNED TO LADOT	
UNITS	MATERIAL
ALL	LED Pedestrian Heads

- NOTES:
- FULLY-ACTUATED OPERATION WITH TRANSIT PRIORITY AND ATSAC CAMERA (ATSAC 2070 CONTROLLER IN 332 CABINET)  
 #1 - SANTA MONICA BLVD. EB LT  
 #2 - SANTA MONICA BLVD. WB & N/S PED. XING  
 #3 - SEPULVEDA BLVD. NB LT  
 #4 - SEPULVEDA BLVD. SB & W/S PED. XING  
 #5 - SANTA MONICA BLVD. WB LT  
 #6 - SANTA MONICA BLVD. EB & S/S PED. XING  
 #7 - SEPULVEDA BLVD. SB LT  
 #8 - SEPULVEDA BLVD. NB & E/S PED. XING  
 OLA - (#1) SEPULVEDA BLVD. SB RT  
 OLB - (#3) SANTA MONICA BLVD. EB RT  
 OLC - (#7) SANTA MONICA BLVD. WB RT  
 WESTWOOD ATSAC SYSTEM  
 DIRECT WIRE (CABLE) INTERCONNECT
  - SEE STREET LIGHTING SHEET FOR WORK ON STREET LIGHTING FACILITIES.
  - INSTALL DETECTOR LOOPS PER LADOT STD. DWG. NO. S-70.1A.

CONDUCTOR SCHEDULE		RUN																							
SIZE No.	CABLE / WIRE	1	2	3	4	5	6	7	8	9	10	11	12	13	14	15	16	17	18	19	20	21	22	23	24
5	CONDUCTOR CABLE 5 X #14	4																							
9	CONDUCTOR CABLE 8 X #14 & 1 X #12 (COM)	1																							
12	CONDUCTOR CABLE 11 X #14 & 1 X #12 (COM)																								
28	CONDUCTOR CABLE 27 X #14 & 1 X #10 (COM)	1																							
4	SERVICE																								
14	PED PUSH BUTTON	2																							
16	DLC (2 PAIR)	1	1																						
16	DLC (3 PAIR)	1	1	1																					
16	DLC (4 PAIR)	1	1	1	1																				
22	INTERCONNECT (12 PAIR)	1	1	1	1																				
22	INTERCONNECT (25 PAIR)	1	1	1	1	1																			
22	INTERCONNECT (75 PAIR)	1	1	1	1	1	1																		
12	BUS DLC (1 PAIR)	1	2																						
12	VIDEO FIBER (6 SM)																								
6	CMS SERVICE																								
**	VIDEO FIBER (24 SM)																								
**	CMS SIGN POWER/CONTROL																								
	CONDUIT SIZE (mm)	51	51	76	76	76	76	51	51	76	76	76	76	76	51	51	76	76	76	76	76	76	51	51	

\* Existing  
 \*\* Cable(s) Furnished by Sign Manufacturer

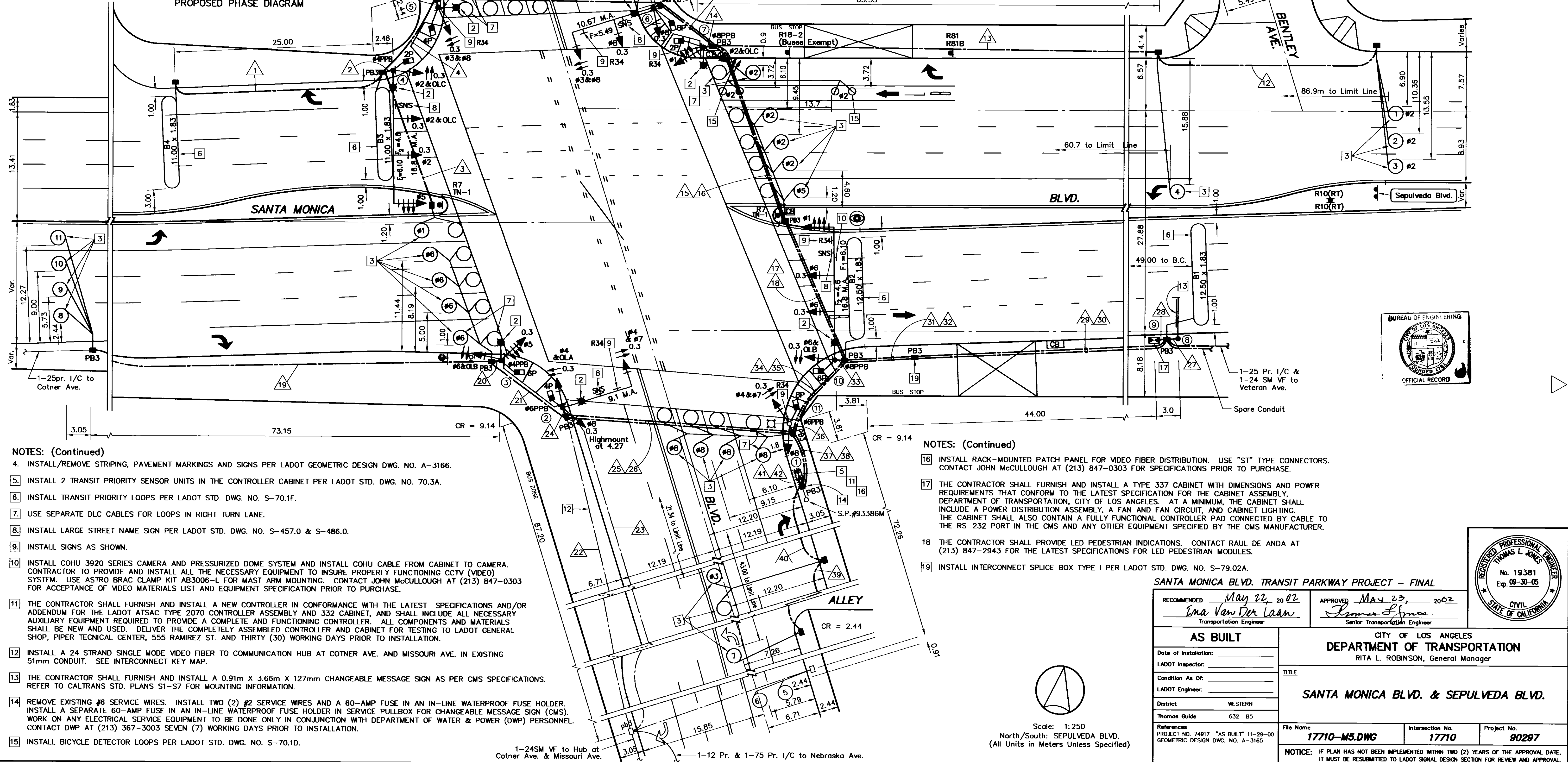

- NOTES: (Continued)
- INSTALL/REMOVE STRIPING, PAVEMENT MARKINGS AND SIGNS PER LADOT GEOMETRIC DESIGN DWG. NO. A-3166.
  - INSTALL 2 TRANSIT PRIORITY SENSOR UNITS IN THE CONTROLLER CABINET PER LADOT STD. DWG. NO. 70.3A.
  - INSTALL TRANSIT PRIORITY LOOPS PER LADOT STD. DWG. NO. S-70.1F.
  - USE SEPARATE DLC CABLES FOR LOOPS IN RIGHT TURN LANE.
  - INSTALL LARGE STREET NAME SIGN PER LADOT STD. DWG. NO. S-457.0 & S-486.0.
  - INSTALL SIGNS AS SHOWN.
  - INSTALL COHU 3920 SERIES CAMERA AND PRESSURIZED DOME SYSTEM AND INSTALL COHU CABLE FROM CABINET TO CAMERA. CONTRACTOR TO PROVIDE AND INSTALL ALL THE NECESSARY EQUIPMENT TO INSURE PROPERLY FUNCTIONING CCTV (VIDEO) SYSTEM. USE ASTRO BRAC CLAMP KIT AB3006-L FOR MAST ARM MOUNTING. CONTACT JOHN McCULLOUGH AT (213) 847-0303 FOR ACCEPTANCE OF VIDEO MATERIALS LIST AND EQUIPMENT SPECIFICATION PRIOR TO PURCHASE.
  - THE CONTRACTOR SHALL FURNISH AND INSTALL A NEW CONTROLLER IN CONFORMANCE WITH THE LATEST SPECIFICATIONS AND/OR ADDENDUM FOR THE LADOT ATSAC TYPE 2070 CONTROLLER ASSEMBLY AND 332 CABINET, AND SHALL INCLUDE ALL NECESSARY AUXILIARY EQUIPMENT REQUIRED TO PROVIDE A COMPLETE AND FUNCTIONING CONTROLLER. ALL COMPONENTS AND MATERIALS SHALL BE NEW AND USED. DELIVER THE COMPLETELY ASSEMBLED CONTROLLER AND CABINET FOR TESTING TO LADOT GENERAL SHOP, PIPER TECHNICAL CENTER, 555 RAMIREZ ST. AND THIRTY (30) WORKING DAYS PRIOR TO INSTALLATION.
  - INSTALL A 24 STRAND SINGLE MODE VIDEO FIBER TO COMMUNICATION HUB AT COTNER AVE. AND MISSOURI AVE. IN EXISTING 51mm CONDUIT. SEE INTERCONNECT KEY MAP.
  - THE CONTRACTOR SHALL FURNISH AND INSTALL A 0.91m X 3.66m X 127mm CHANGEABLE MESSAGE SIGN AS PER CMS SPECIFICATIONS. REFER TO CALTRANS STD. PLANS S1-S7 FOR MOUNTING INFORMATION.
  - REMOVE EXISTING #6 SERVICE WIRES. INSTALL TWO (2) #2 SERVICE WIRES AND A 60-AMP FUSE IN AN IN-LINE WATERPROOF FUSE HOLDER. INSTALL A SEPARATE 60-AMP FUSE IN AN IN-LINE WATERPROOF FUSE HOLDER IN SERVICE PULLBOX FOR CHANGEABLE MESSAGE SIGN (CMS). WORK ON ANY ELECTRICAL SERVICE EQUIPMENT TO BE DONE ONLY IN CONJUNCTION WITH DEPARTMENT OF WATER & POWER (DWP) PERSONNEL. CONTACT DWP AT (213) 367-3003 SEVEN (7) WORKING DAYS PRIOR TO INSTALLATION.
  - INSTALL BICYCLE DETECTOR LOOPS PER LADOT STD. DWG. NO. S-70.1D.

- NOTES: (Continued)
- INSTALL RACK-MOUNTED PATCH PANEL FOR VIDEO FIBER DISTRIBUTION. USE "ST" TYPE CONNECTORS. CONTACT JOHN McCULLOUGH AT (213) 847-0303 FOR SPECIFICATIONS PRIOR TO PURCHASE.
  - THE CONTRACTOR SHALL FURNISH AND INSTALL A TYPE 337 CABINET WITH DIMENSIONS AND POWER REQUIREMENTS THAT CONFORM TO THE LATEST SPECIFICATION FOR THE CABINET ASSEMBLY, DEPARTMENT OF TRANSPORTATION, CITY OF LOS ANGELES. AT A MINIMUM, THE CABINET SHALL INCLUDE A POWER DISTRIBUTION ASSEMBLY, A FAN AND FAN CIRCUIT, AND CABINET LIGHTING. THE CABINET SHALL ALSO CONTAIN A FULLY FUNCTIONAL CONTROLLER PAD CONNECTED BY CABLE TO THE RS-232 PORT IN THE CMS AND ANY OTHER EQUIPMENT SPECIFIED BY THE CMS MANUFACTURER.
  - THE CONTRACTOR SHALL PROVIDE LED PEDESTRIAN INDICATIONS. CONTACT RAUL DE ANDA AT (213) 847-2943 FOR THE LATEST SPECIFICATIONS FOR LED PEDESTRIAN MODULES.
  - INSTALL INTERCONNECT SPLICE BOX TYPE I PER LADOT STD. DWG. NO. S-79.02A.

SANTA MONICA BLVD. TRANSIT PARKWAY PROJECT - FINAL

RECOMMENDED: May 22, 2002  
 Thomas Van Der Laan  
 Transportation Engineer

APPROVED: May 23, 2002  
 Thomas L. Jones  
 Senior Transportation Engineer

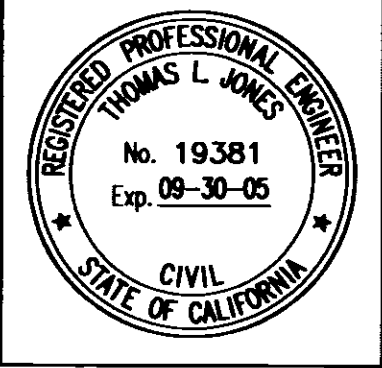

AS BUILT		CITY OF LOS ANGELES DEPARTMENT OF TRANSPORTATION RITA L. ROBINSON, General Manager	
Date of Installation:	LADOT Inspector:	TITLE	
Condition As Of:	LADOT Engineer:	SANTA MONICA BLVD. & SEPULVEDA BLVD.	
District: WESTERN	Thomas Guide: 632 B5	File Name: 17710-MS.DWG	Intersection No. 17710
References: PROJECT NO. 74917 "AS BUILT" 11-29-00 GEOMETRIC DESIGN DWG. NO. A-3165		Project No. 90297	

NOTICE: IF PLAN HAS NOT BEEN IMPLEMENTED WITHIN TWO (2) YEARS OF THE APPROVAL DATE, IT MUST BE RESUBMITTED TO LADOT SIGNAL DESIGN SECTION FOR REVIEW AND APPROVAL.

(LADOT Revised 9/96)