

SIGNAL STANDARD SCHEDULE					REMARKS
No.	TYPE	FOUND. TYPE	PED. PUSH BUTN TYPE	PHASE	
1	332 Cab.	F-332*			ATSAC 2070 Controller in 332 Cabinet
2	BSL*	BSL*			
3	BSL*	BSL*	0.15	8	
4	1	F-1	0.10	8	Modified F-1 Foundation Per Detail "C"
5	1	F-1	0.10	1	Modified F-1 Foundation Per Detail "C"
6	Davit *	CIDH**	0.15	1	9.1m Mast Arm; 19-4-129 Foundation
7	16	F-2			
8	Davit *	CIDH**			15.2m Mast Arm; 29-5-129 Foundation
9	1	F-1			

* For reference only. See street lighting sheet
 ** Per CALTRANS Std. Plan Nos. ES-7F, ES-7G, ES-7M & ES-7N

- NOTES:
- SEMI-ACTUATED OPERATION W/ TRANSIT PRIORITY (ATSAC 2070 CONTROLLER IN 332 CABINET)
 - CENTURY PARK WEST W/S PED. XING (NORTH SIDE)
 - SANTA MONICA BLVD. WB
 - TIMING ONLY
 - CENTURY PARK WEST NB, NB LT & NB RT
 - TIMING ONLY
 - SANTA MONICA BLVD. EB & S/S PED. XING
 - TIMING ONLY
 - CENTURY PARK WEST W/S PED. XING (SOUTH SIDE)
 - OLA (#3 & #5) - SANTA MONICA BLVD. WB LT
 - OLB (#7) - SANTA MONICA BLVD. EB RT
 - WESTWOOD ATSAC SYSTEM
 - DIRECT WIRE (CABLE) INTERCONNECT

ESTIMATED MATERIAL FURNISHED BY LADOT	
UNITS	MATERIAL

- INSTALL/REMOVE STRIPING, PAVEMENT MARKINGS AND SIGNS PER LADOT GEOMETRIC DESIGN DWG. NO. A-3186.
- INSTALL DETECTOR LOOPS PER LADOT STD. DWG. NO. S-70.1A.
- SEE STREET LIGHTING SHEET FOR WORK ON STREET LIGHTING FACILITIES.
- THE CONTRACTOR SHALL FURNISH AND INSTALL A NEW CONTROLLER IN CONFORMANCE WITH THE LATEST SPECIFICATIONS AND/OR ADDENDUM FOR THE LADOT ATSAC TYPE 2070 CONTROLLER ASSEMBLY AND 332 CABINET, AND SHALL INCLUDE ALL NECESSARY AUXILIARY EQUIPMENT REQUIRED TO PROVIDE A COMPLETE AND FUNCTIONING CONTROLLER. ALL COMPONENTS AND MATERIALS SHALL BE NEW AND UNUSED. DELIVER THE COMPLETELY ASSEMBLED CONTROLLER AND CABINET FOR TESTING TO LADOT GENERAL SHOP, PIPER TECHNICAL CENTER, 555 RAMIREZ ST. AND THIRTY (30) WORKING DAYS PRIOR TO INSTALLATION.
- INSTALL TRANSIT PRIORITY LOOP PER LADOT STD. DWG. NO. S-70.1F.
- INSTALL TRANSIT PRIORITY SENSOR UNIT IN THE CONTROLLER CABINET PER LADOT STD. DWG. NO. S-70.3A.

ESTIMATED SALVAGE MATERIAL TO BE RETURNED TO LADOT	
UNITS	MATERIAL
ALL	LED PEDESTRIAN HEADS

CONDUCTOR SCHEDULE		RUN															
SIZE No.	CABLE / WIRE	1	2	3	4	5	6	7	8	9	10	11	12	13	14	15	16
5	CONDUCTOR CABLE 5 X #14																
9	CONDUCTOR CABLE 8 X #14 & 1 X #12 (COM)																
12	CONDUCTOR CABLE 11 X #14 & 1 X #12 (COM)																
28	CONDUCTOR CABLE 27 X #14 & 1 X #12 (COM)																
4	SERVICE																
14	PED PUSH BUTTON																
16	DLC (2 PAIR)																
16	DLC (3 PAIR)																
22	INTERCONNECT (12 PAIR)																
22	INTERCONNECT (25 PAIR)																
12	BUS DLC (1 PAIR)																
	VIDEO FIBER (24 SM)																
	CONDUIT SIZE (mm)	51	51	76	51	51	51	76	51	51	76	76	51	76	51	76	

* Existing

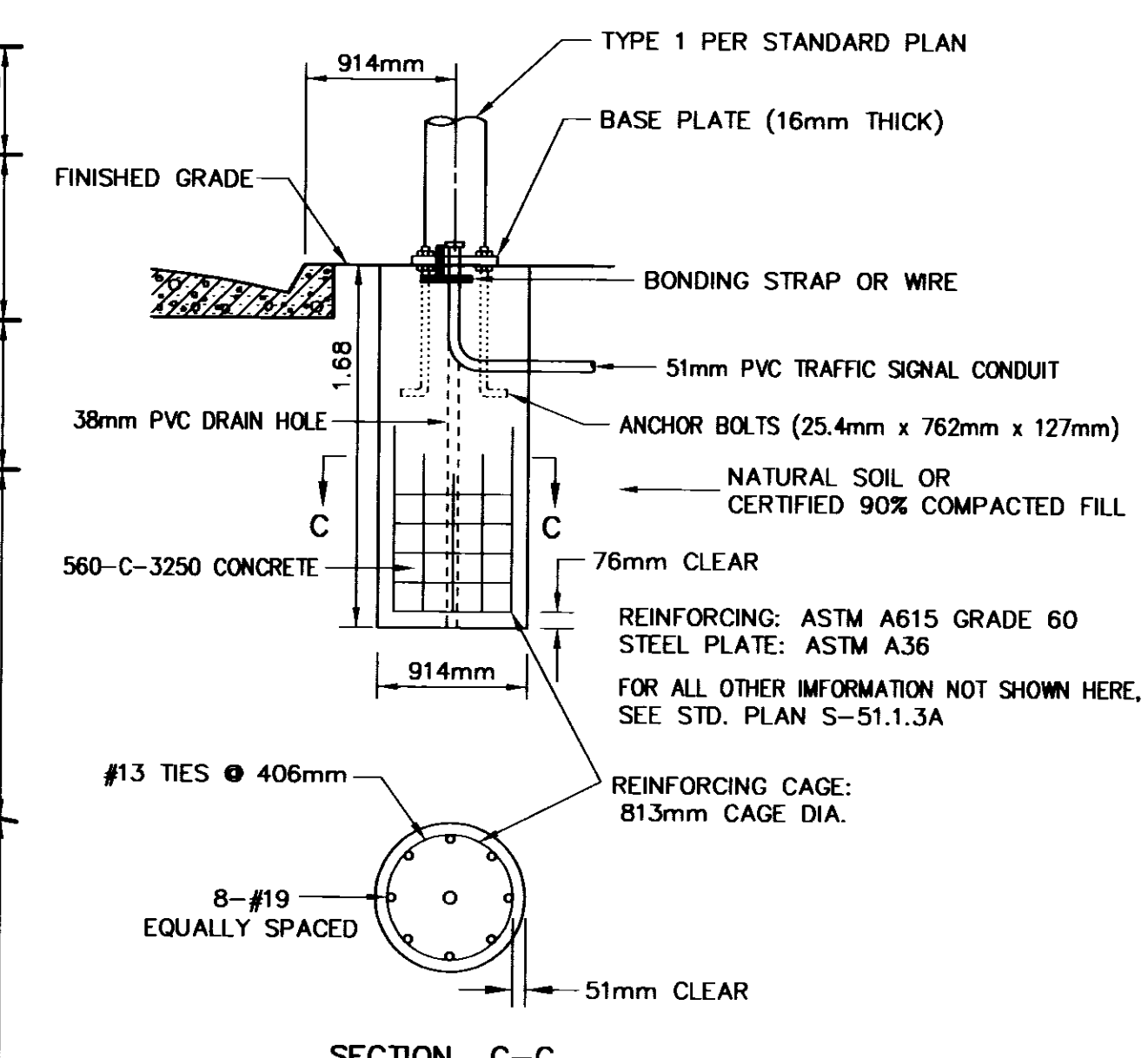
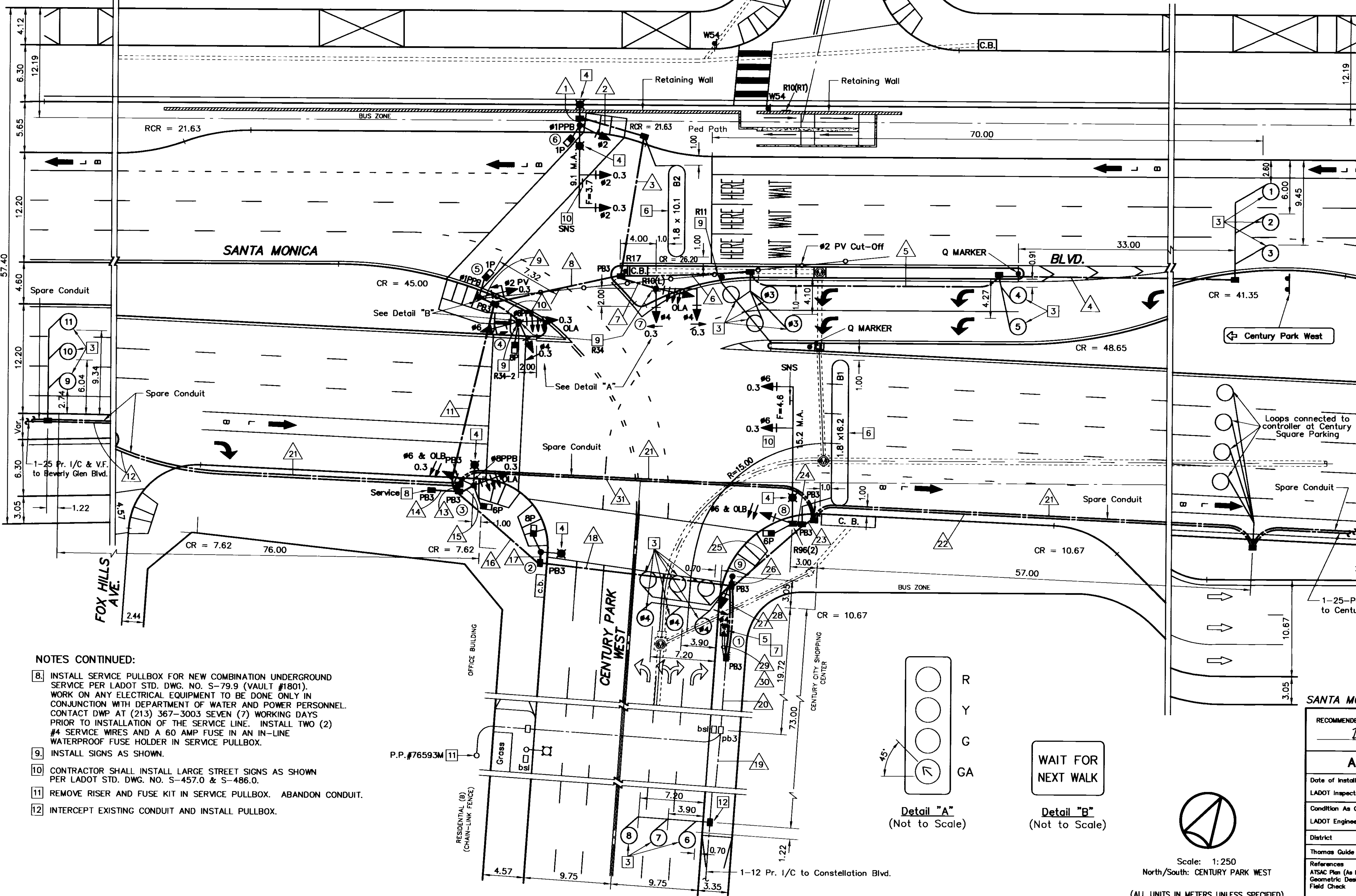
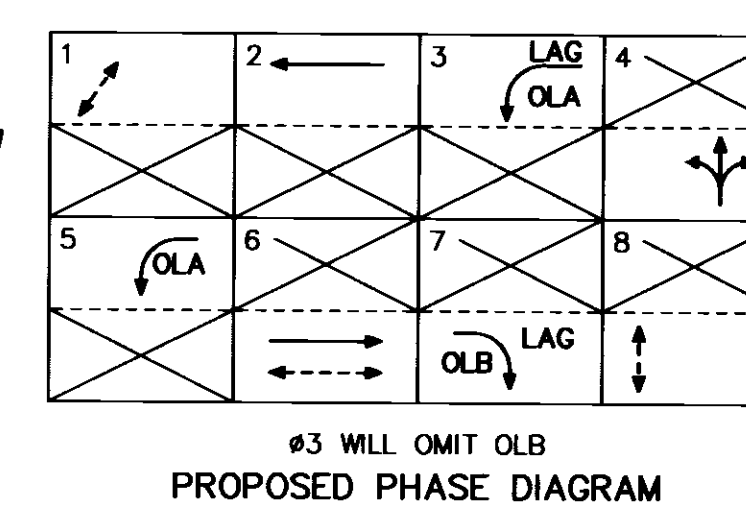

DETAIL "C" - MODIFIED F-1 FOUNDATION (NON-CONSTRAINED) NOT TO SCALE

- NOTES CONTINUED:
- INSTALL SERVICE PULLBOX FOR NEW COMBINATION UNDERGROUND SERVICE PER LADOT STD. DWG. NO. S-79.9 (VAULT #1801). WORK ON ANY ELECTRICAL EQUIPMENT TO BE DONE ONLY IN CONJUNCTION WITH DEPARTMENT OF WATER AND POWER PERSONNEL. CONTACT DWP AT (213) 367-3003 SEVEN (7) WORKING DAYS PRIOR TO INSTALLATION OF THE SERVICE LINE. INSTALL TWO (2) #4 SERVICE WIRES AND A 60 AMP FUSE IN AN IN-LINE WATERPROOF FUSE HOLDER IN SERVICE PULLBOX.
 - INSTALL SIGNS AS SHOWN.
 - CONTRACTOR SHALL INSTALL LARGE STREET SIGNS AS SHOWN PER LADOT STD. DWG. NO. S-457.0 & S-486.0.
 - REMOVE RISER AND FUSE KIT IN SERVICE PULLBOX. ABANDON CONDUIT.
 - INTERCEPT EXISTING CONDUIT AND INSTALL PULLBOX.

